

Loop & Needle (#90001/90010)

1. Description

Disposable Loop and Needle consists of a loop on one side and a needle on the other, used for the inoculation of microorganisms. Two different sizes are available.

2. Features

- ❖ For microbe inoculation
- ❖ Dual purpose : a loop on one end and needle on the other
- ❖ Color coded for sizes (White for 1 μl , Blue for 10 μl)

3. Functional Test

| | | |
|------------------|---|--------|
| Sterilized | : | Passed |
| RNase/DNase free | : | Passed |
| DNA free | : | Passed |

4. Product Range

| Cat. No. | Material | Size (μl) | Length (mm) | Sterile | Packaging |
|----------|----------|------------------------|-------------|---------|-----------|
| 90001 | PP | 1.00 | 195.00 | + | 10 / 500 |
| 90010 | PP | 10.00 | 195.00 | + | 10 / 500 |

5. Certification

SPL Life Sciences hereby certifies that the product identified above, inspected to be in compliance with product quality specification and requirements as documented in our ISO 9001:2008 Quality Management System (K-QA-Q031478) in Korea.

6. Product Photographs

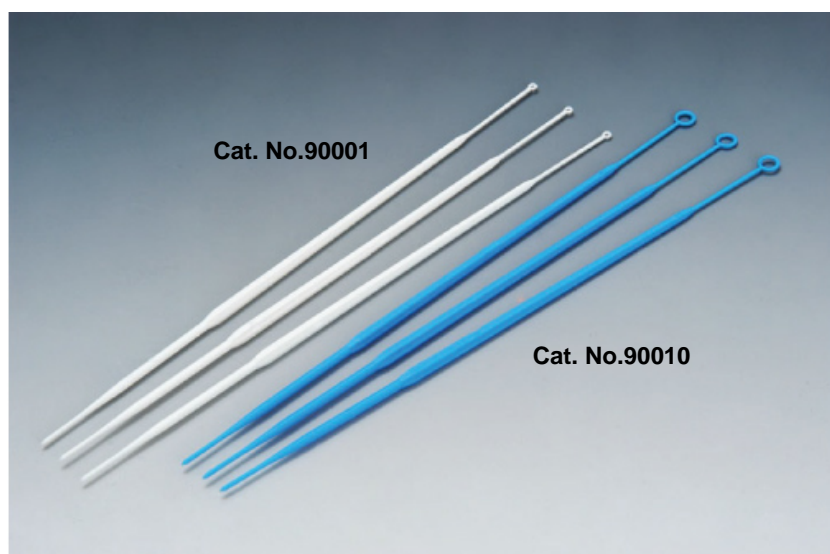

SPL-TDS-LONE

For Research Use Only. Not intended for use in diagnostic or therapeutic procedures.
© SPL Life Sciences Co., Ltd., Version 2, July 12th, 2016

7. Specifications & Technical Drawing

- Specifications

| Dimensions | Material (Resin) | Packaging | |
|-------------|------------------|---|---|
| | | 90001 | 90010 |
| Length (mm) | 195.00 | Polypropylene (PP) | |
| | | <ul style="list-style-type: none"> ▪ Pieces/Sleeve: 10 ▪ Pieces/Case: 500 | <ul style="list-style-type: none"> ▪ Pieces/Sleeve: 10 ▪ Pieces/Case: 500 |

- Technical Drawing

Cat. No. 90001

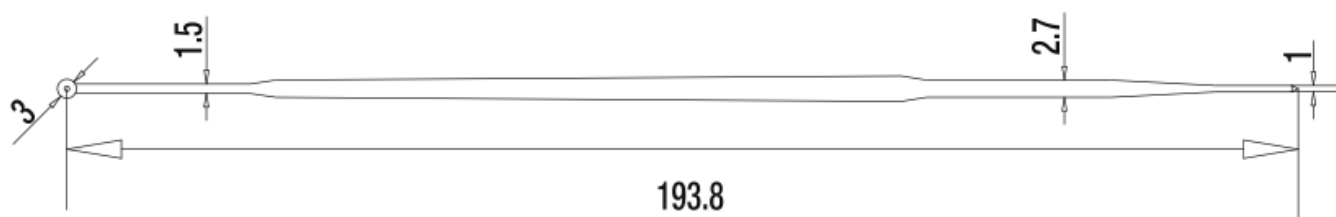

Cat. No. 90010

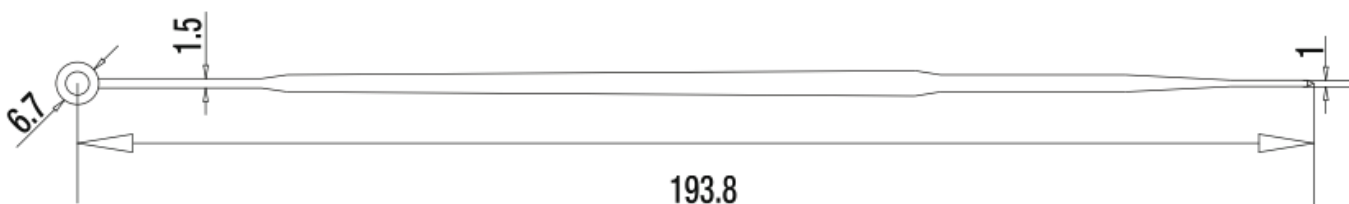

www.spllifesciences.com

For technical assistance, contact SPL R&D Center at:

Tel: +82-31-533-4800; Fax: +82-31-533-1430; e-mail: spl@ispl.co.kr

To place an order, contact your local distributor or

Tel: +82-31-533-4800; Fax: +82-31-533-1430; e-mail: business@ispl.co.kr

SPL-TDS-LONE

For Research Use Only. Not intended for use in diagnostic or therapeutic procedures.

© SPL Life Sciences Co., Ltd., Version 2, July 12th, 2016